

Marine Offshore Gensets

H22CDF I Bore: 220mm, Stroke: 330mm

Main Data

Speed Frequency	900 rpm 60 Hz		1,000 rpm 50 Hz	
	Eng.kW	Gen.kW	Eng.kW	Gen.kW
5H22CDF	1,075	1,011	1,100	1,034
6H22CDF	1,290	1,220	1,320	1,248
7H22CDF	1,505	1,423	1,540	1,463
8H22CDF	1,720	1,634	1,760	1,672
9H22CDF	1,935	1,839	1,980	1,881

Based on alternator efficiency of 94~95 %.

Power adjusting between -5% derating is generally accepted, other power adjusting must be consulted to engine builder.

Heat Rate & SFOC (100% Load)

Load	900 rpm	1,000 rpm
Heat Rate@Gas mode	8,120 kJ/kWh	8,172 kJ/kWh
SFOC@Diesel mode	191.5 g/kWh	193 g/kWh

Specific Lubricating Oil Consumption

Lub. Oil: 0.6 g/kWh



URL: <http://www.soar.hk>
E-mail: sale@soar.hk
Phone: +86-4008111308

Dual Fuel Engine
Tier II, Tier III

Dimensions

Speed	cyl.	Dimension (mm)				Dry Mass (ton)	
		A	B ₁₎	C ₁₎	H	Engine ₂₎	GenSet _{1,3)}
900	5	3,735	2,249	5,984	3,056	16.5	25.4
	6	4,085	2,249	6,334	3,056	18.2	27.6
1,000 rpm	7	4,435	2,305	6,740	3,056	19.9	29.3
	8	4,785	2,305	7,090	3,056	21.6	31.2
	9	5,135	2,450	7,585	3,056	23.3	34.6

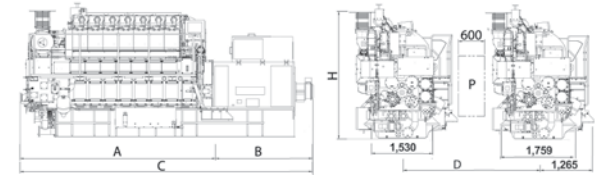

Remarks

- 1) Depending on alternator.
- 2) Without common base frame.
- 3) With common base frame & alternator (Maker: HHI-EES).

D: Min. distance between engines 2,990 mm (with gallery).

P: Free passage between the engines, width 600 mm and height 2,000 mm.

Note) All dimensions and weight are approximate value and subject to change without prior notice.